

Meekland Avenue Corridor Improvements from Blossom Way to E. Lewelling Blvd



Project Introduction and Community Outreach

July 14, 2021

ACPWA
Maritoni Maravilla
Project Manager

Wood Rodgers
Chris Hodge, P.E.
Project Engineer



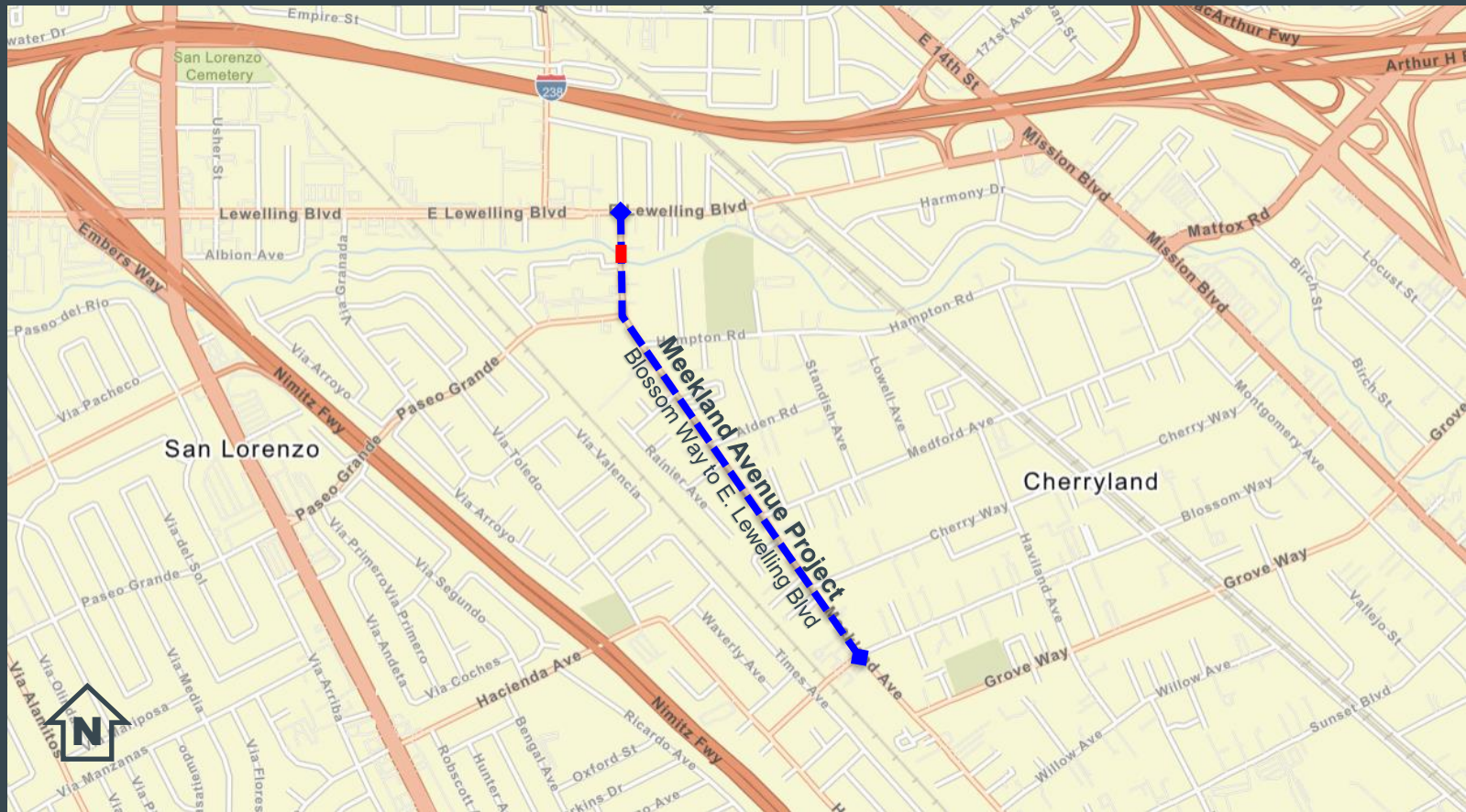

Project Location

Project Features

- Class II Bike Lane
 - New and Reconstructed Sidewalks
 - Pavement Repair
 - Accessibility (ADA) Improvements
 - Street Crossing Improvements
 - Traffic Calming
 - Street Trees
 - Green Infrastructure
- ⇒ Continuation of Phase 1 Improvements
- A Street to Blossom Way



Existing Conditions

- Deteriorating and Discontinuous Sidewalks
- Non-ADA Compliant Sidewalks and Driveways
- Discontinuous Bike Facility along Corridor and across Bridge
- Poor Pavement Condition
- Ponding Water
- 95-year old Bridge with Previous Widening



Bridge and Roadway Improvements

- Bridge
 - Additional Width Required to Add Bike Lane
 - Age and Design Standards are a Factor
 - Replacement is a Better Alternative than an Additional Widening
- General Roadway
 - Resurface Travel Lanes
 - Reconstruct Parking Lanes and Bike Lanes
- Additional Improvements
 - Reconstruct Sidewalks and Driveways (ADA)
 - High Visibility Crosswalks and Ramps at Bulb Outs
 - Add Street Trees and “Clean Water” Features
 - Improve Street Drainage

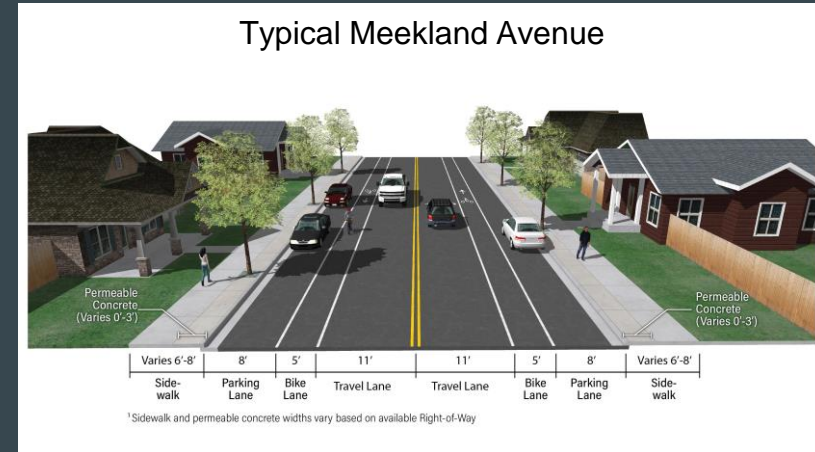
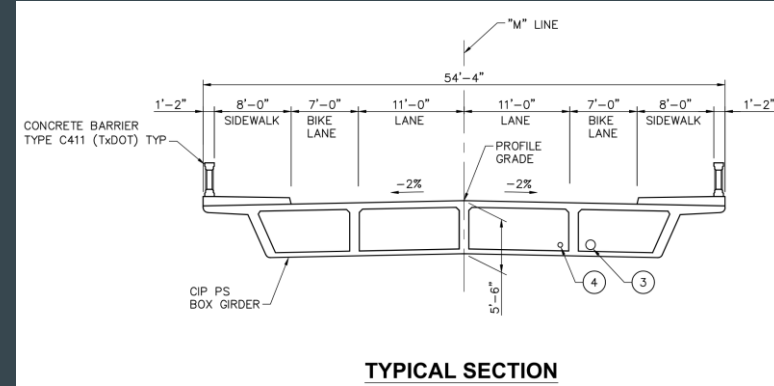

Bicyclist-Friendly Improvements

- Bicycle & Pedestrian Master Plan – Class II Facility
- Complete Network from A Street to E Lewelling Blvd
- Bicycle Facilities on Bridge
- Striping for Bicycle Lane and “Green” Lane Transition Alerts
- Bike Lane Separate from Parking Lane

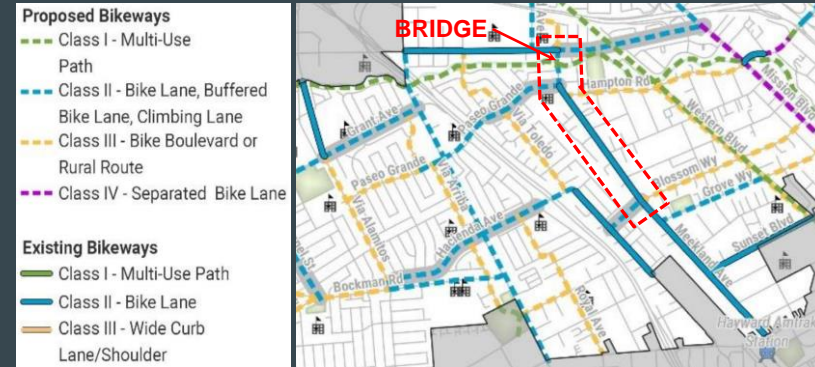

Where are we at right now?

- Design 20% Complete
- Environmental Studies and Clearance Summer 2021 through Winter 2022
- Complete Design Summer 2022
- Construct Project Summer 2023 through Fall 2024

Overview Project Layout and General Features

- “Per Block” Segment Breakouts
 - Blossom Way to Cherry Way
 - Cherry Way to Medford Avenue
 - Medford Avenue to Alden Road
 - Alden Road to Shasta Street
 - Shasta Street to Hampton Road
 - Hampton Road to Paseo Grande (+ North Mid-Block)
 - Paseo Grande (+ North Mid-Block) to E Lewelling Boulevard

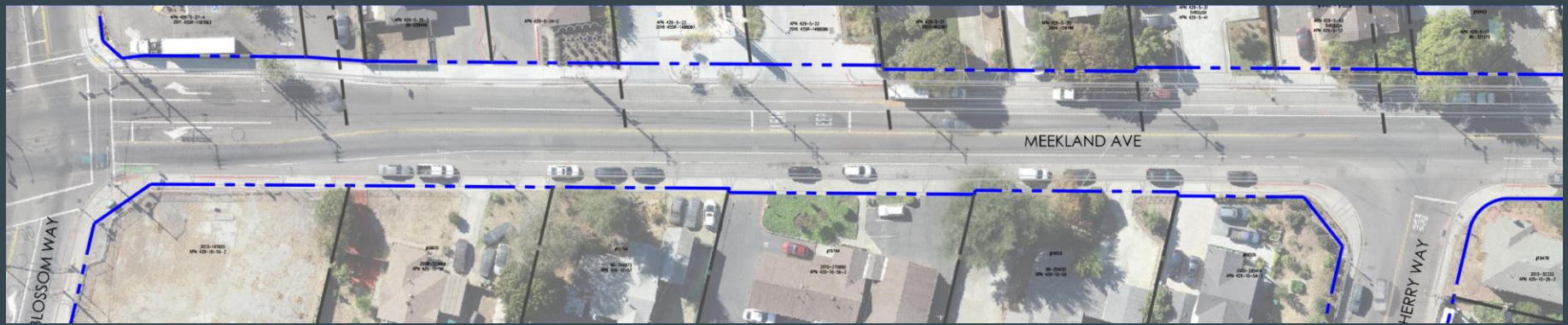

* — · — · — = Indicates existing roadway Right of Way

Existing

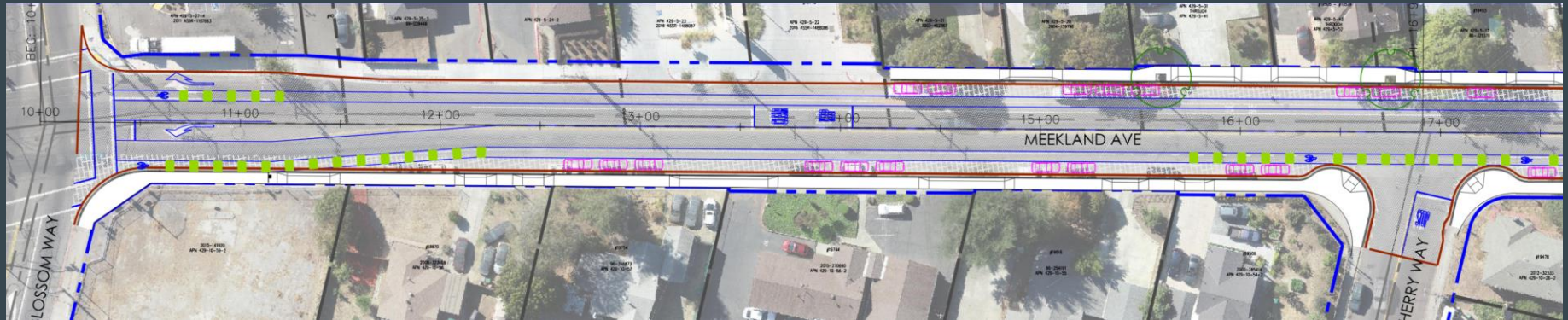

* — · — · — = Indicates existing roadway Right of Way

Proposed

Blossom Way to Cherry Way

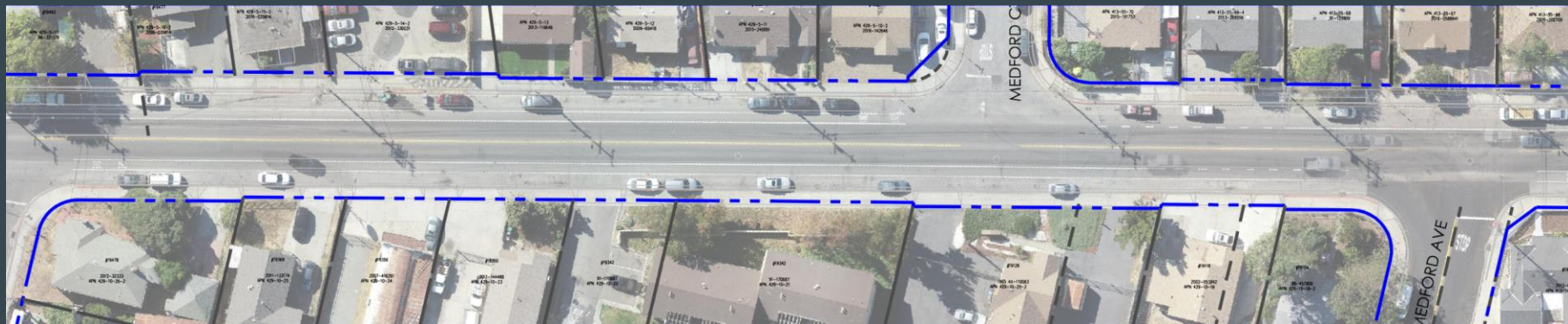

* - - - - = Indicates existing roadway Right of Way

Existing

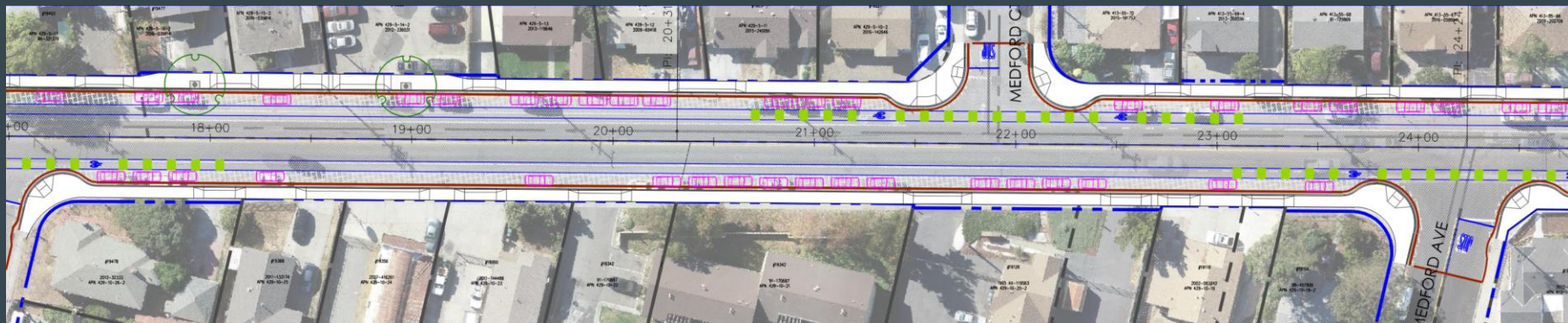

* - - - - = Indicates existing roadway Right of Way

Proposed

Cherry Way to Medford Avenue



* - - - = Indicates existing roadway Right of Way

Existing

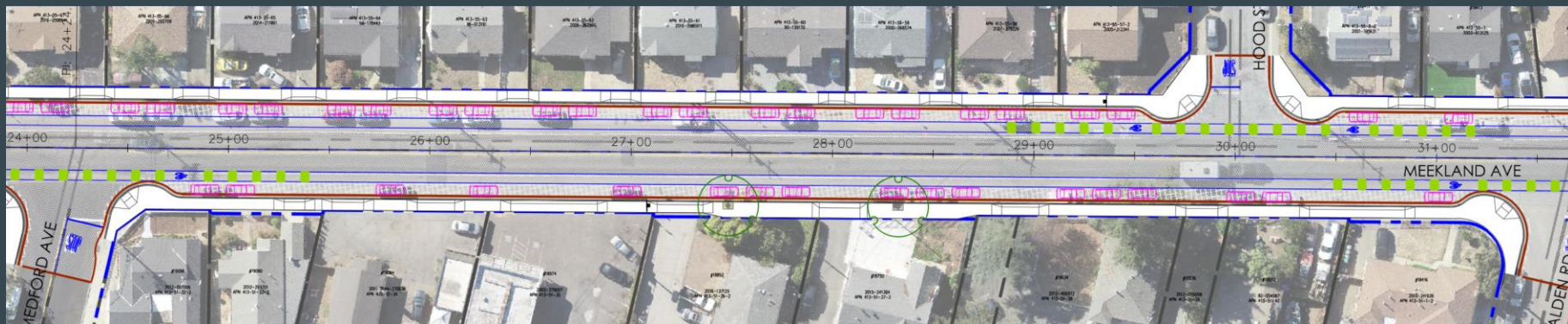

* - - - = Indicates existing roadway Right of Way

Proposed

Medford Avenue to Alden Road

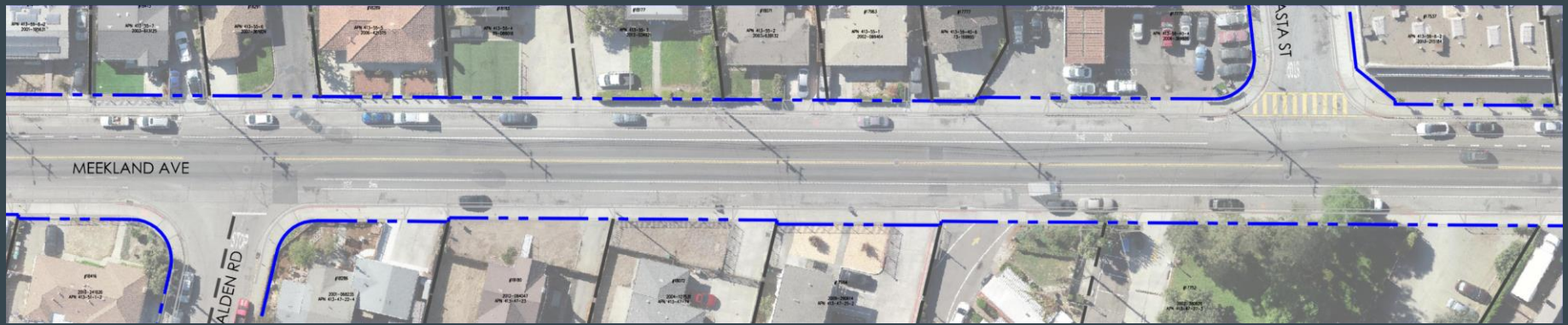

* - - - = Indicates existing roadway Right of Way

Existing

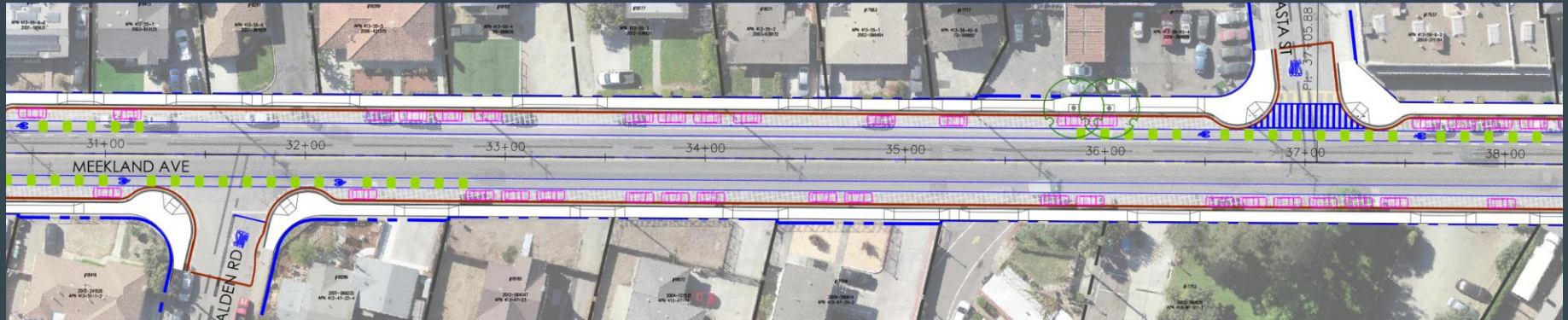

* - - - = Indicates existing roadway Right of Way

Proposed

Alden Road to Shasta Street

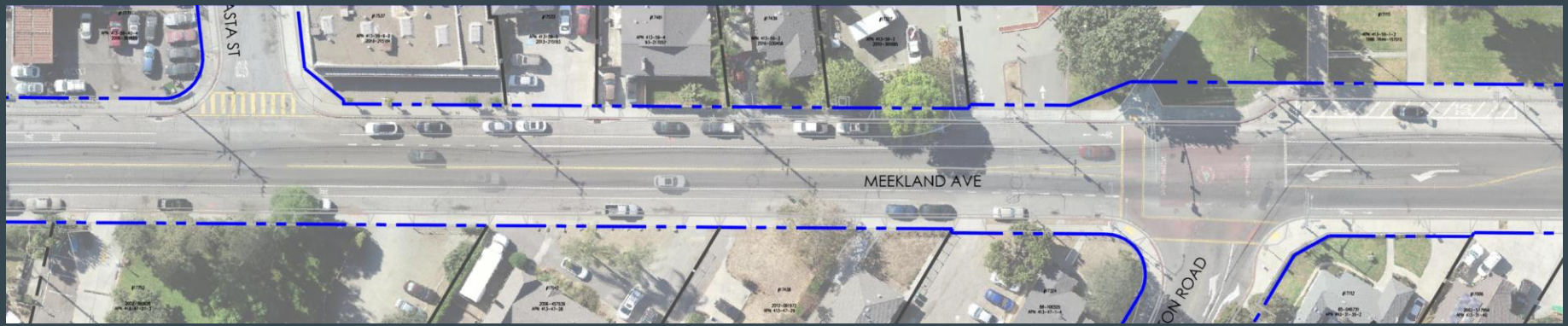

* - - - = Indicates existing roadway Right of Way

Existing

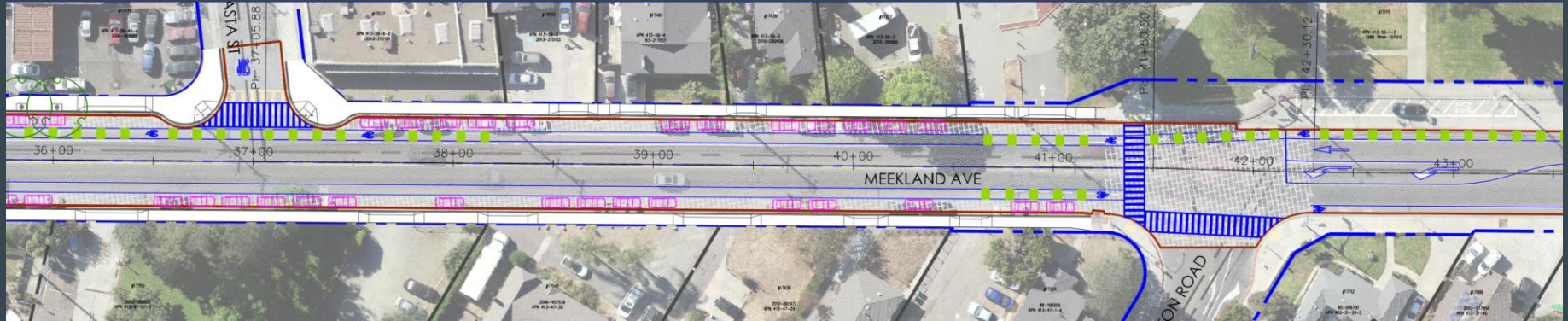

* - - - = Indicates existing roadway Right of Way

Proposed

Shasta Street to Hampton Road

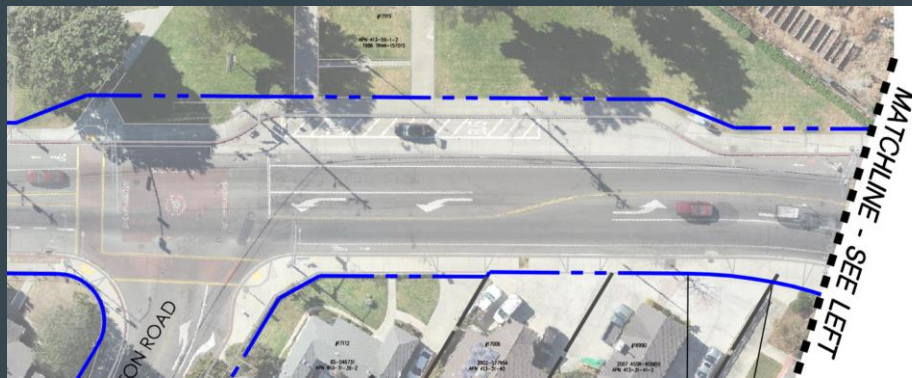

* — — — — = Indicates existing roadway Right of Way



Existing

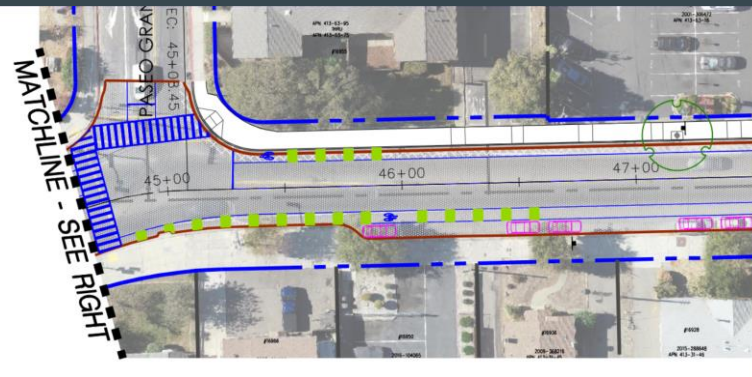
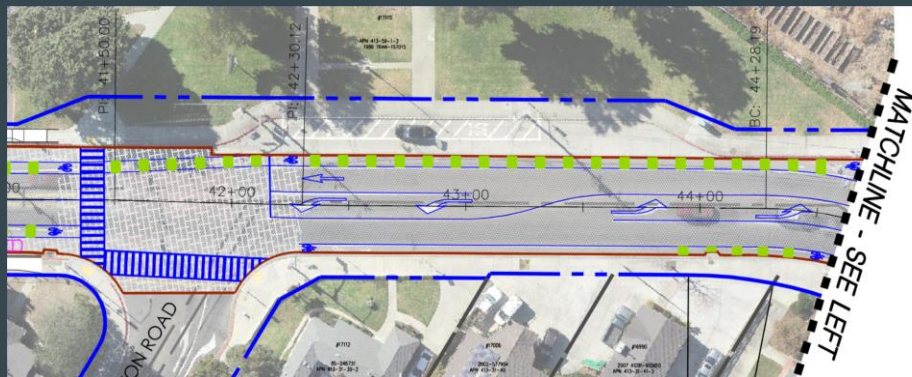

* — — — — = Indicates existing roadway Right of Way

Proposed

Hampton Road to Paseo Grande (+North Mid-Block)

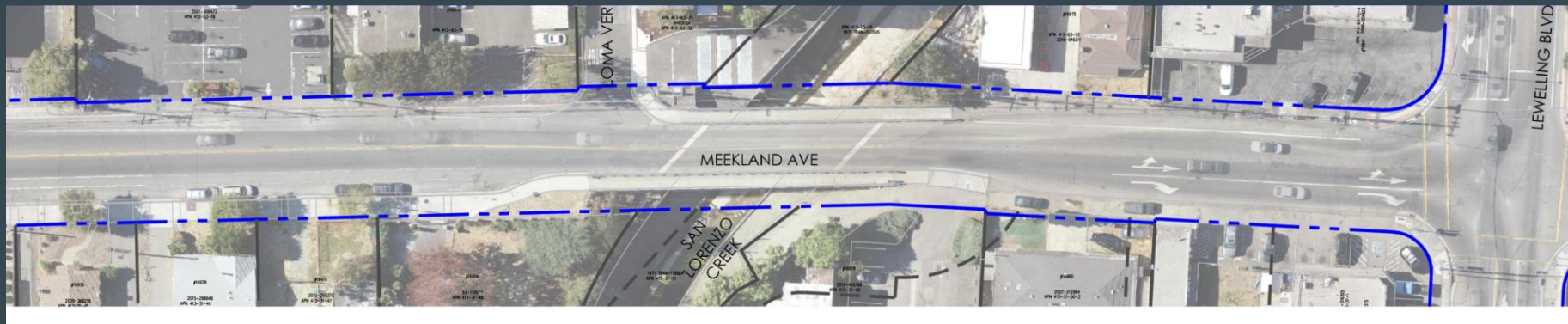

* — — — — = Indicates existing roadway Right of Way

Existing

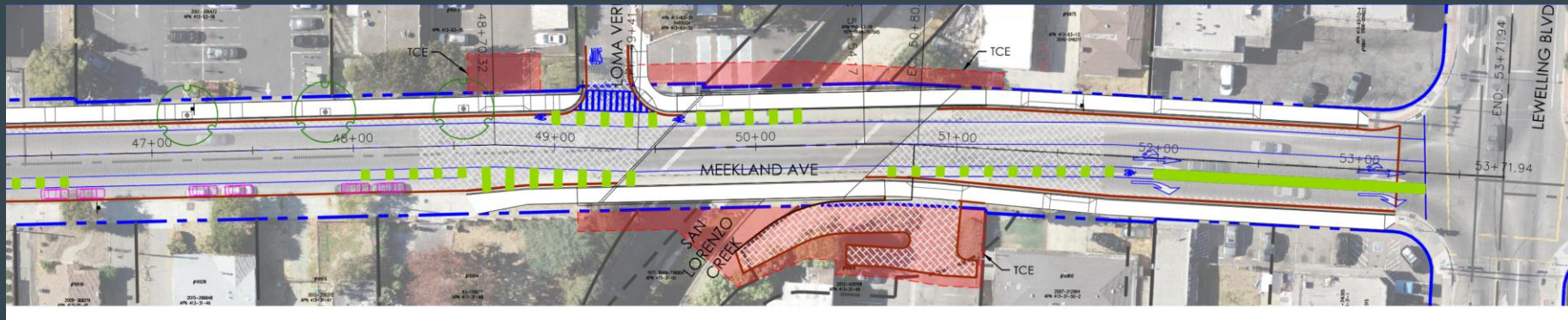

* — — — — = Indicates existing roadway Right of Way

Proposed

Paseo Grande (+North Mid-Block) to E Lewelling Boulevard

Questions/Feedback



Project Contact Information

Maritoni Maravilla
Project Manager
Engineering Department

info@acpwa.org

Additional Questions, Comments, and Exhibits

<https://www.acpwa.org/projects/2021/Meekland-Avenue/Meekland-Avenue.page?>

