

W.O. NO. R23501

SPEC. NO. 2494

COUNTY OF ALAMEDA ★ PUBLIC WORKS AGENCY

2024-2025
THE ASPHALT RUBBER STREET SEALING OF PORTIONS OF
VARIOUS ROADWAYS IN ALAMEDA COUNTY
LOCATION MAP

DRAWN SH	CHECKED SH	DATE AUG 2024	SCALE NONE	FILE NO. —	SHEET NO. 1 OF 3
-------------	---------------	------------------	---------------	---------------	---------------------

G:\Engineering and Construction\Road Design\CURRENT PROJECTS\2024-2025 PMP\2025 Microseal Spec 2494\Location Map\2025 Microseal Spec 2494 ARSS Microseal 25 Location Map.dwg 2-19-25 05:38:31 PM steveh

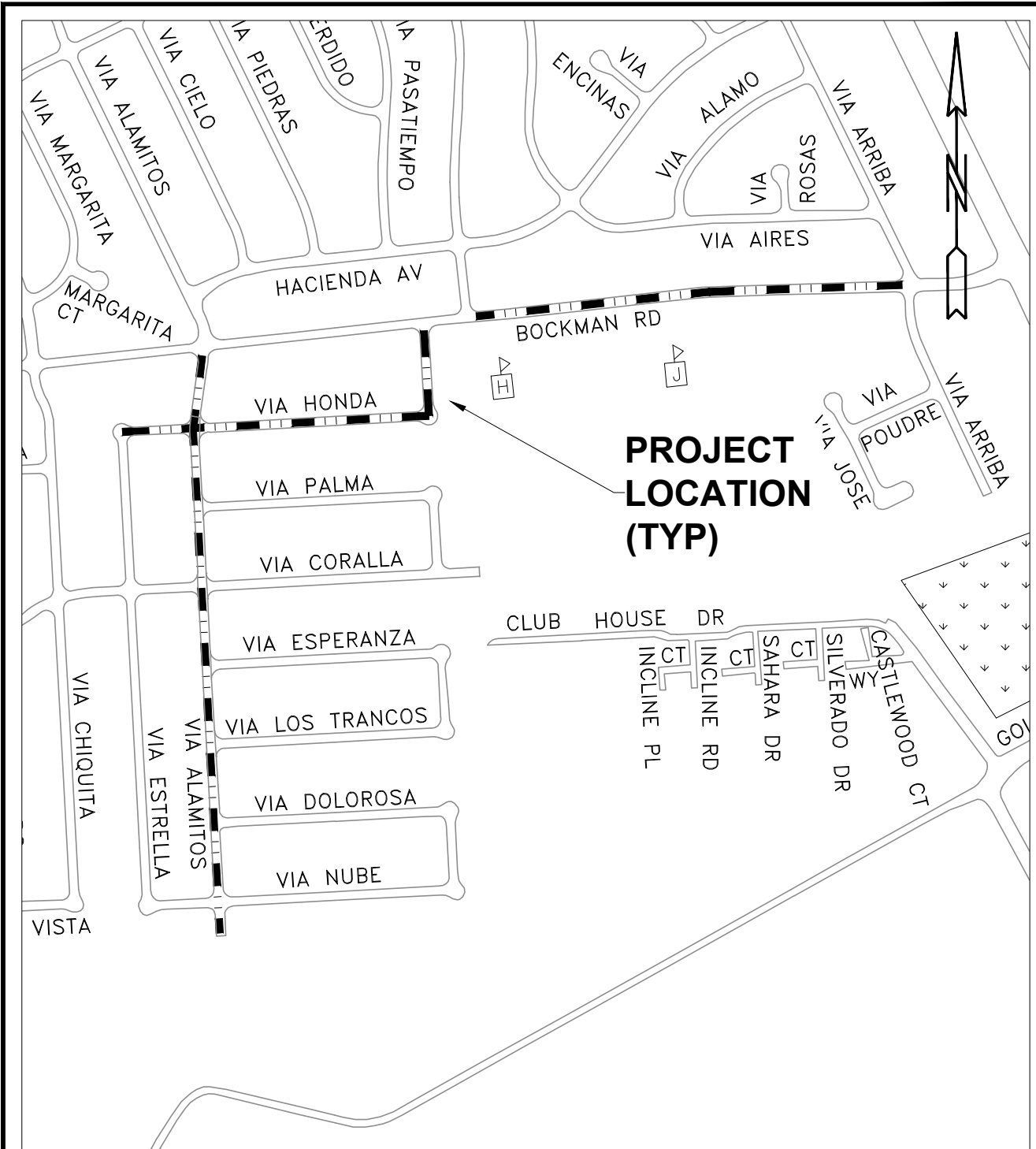

W.O. NO. R23501

SPEC. NO. 2494

COUNTY OF ALAMEDA ★ PUBLIC WORKS AGENCY

2024-2025
THE ASPHALT RUBBER STREET SEALING OF PORTIONS OF
VARIOUS ROADWAYS IN ALAMEDA COUNTY
LOCATION MAP

DRAWN	SH	CHECKED	SH	DATE	AUG 2024	SCALE	NONE	FILE NO.	—	SHEET NO.	2 OF 3
-------	----	---------	----	------	----------	-------	------	----------	---	-----------	--------

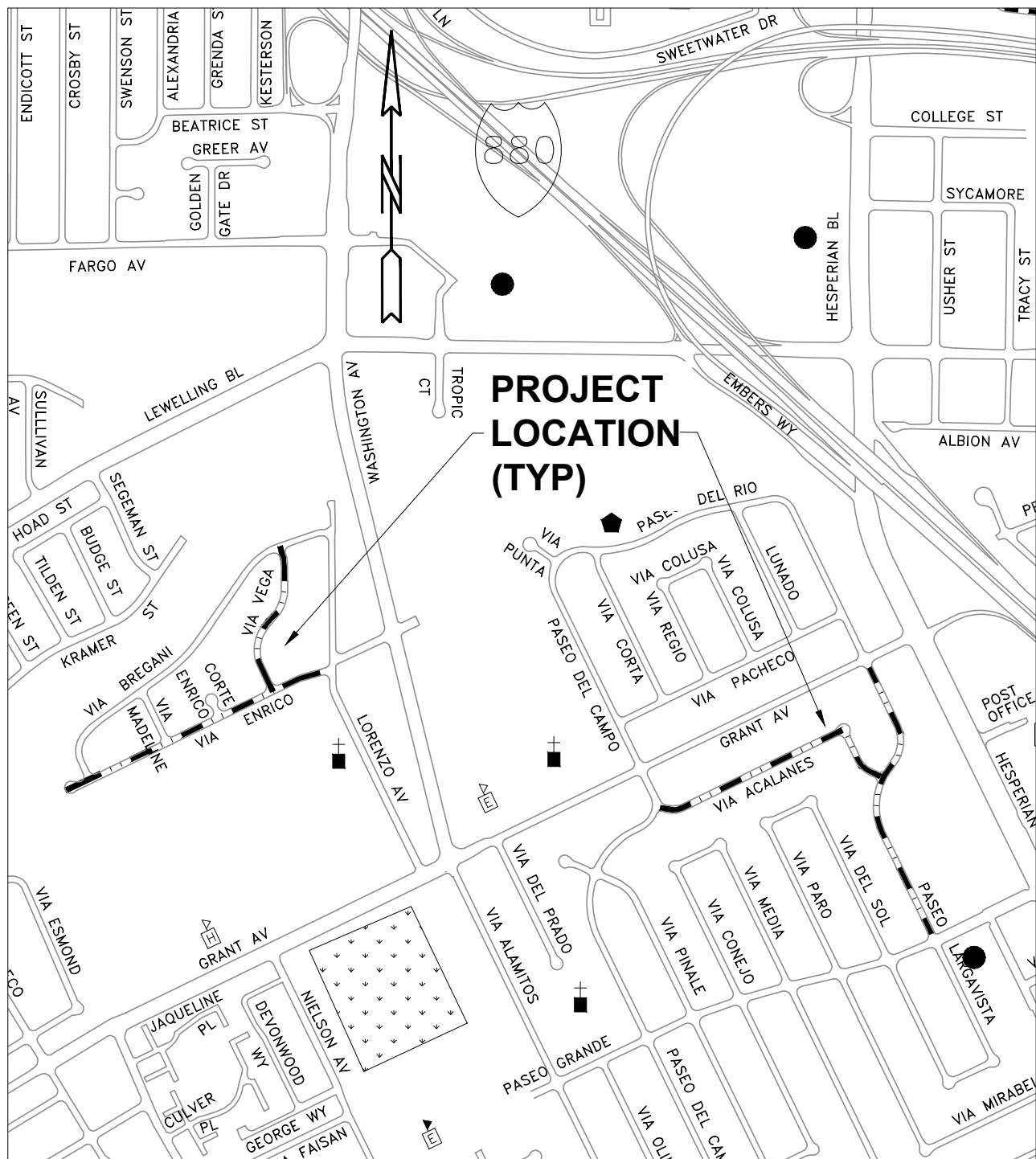

W.O. NO. R23501

SPEC. NO. 2494

COUNTY OF ALAMEDA ★ PUBLIC WORKS AGENCY

2024-2025
THE ASPHALT RUBBER STREET SEALING OF PORTIONS OF
VARIOUS ROADWAYS IN ALAMEDA COUNTY
LOCATION MAP

DRAWN SH	CHECKED SH	DATE AUG 2024	SCALE NONE	FILE NO. —	SHEET NO. 3 OF 3
-------------	---------------	------------------	---------------	---------------	---------------------